

## Ball float steam trap

- ▶ DN15 – DN100
- ▶ PN16 – PN160 / ANSI150 – ANSI900
- ▶ Temperature up to 550°C
- ▶ Back pressure-free condensate discharge even at extreme pressure- and quantity fluctuations
- ▶ Controller with integrated automatic ventilation (except Fig. 630)
- ▶ multiple ...
- ▶ body material, for example
  - ▶ EN-JL 1040
  - ▶ EN-JS1049
  - ▶ 1.0460
  - ▶ 1.4301
  - ▶ 1.4541
  - ▶ 16Mo3
- ▶ Robust and insensitive to water-hammer
- ▶ Non return protection (except 633/637/638)
- ▶ Union for recovery pipe and bypass possible
- ▶ The controller maybe changed without disturbing the pipe work
- ▶ optional
  - ▶ blow down valve

# CONA<sup>®</sup> S - Details

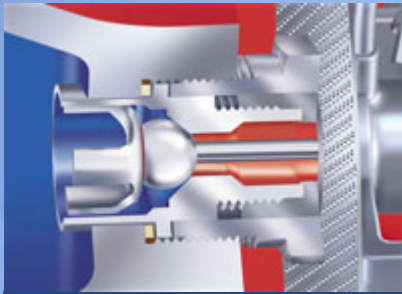

Check valve incorporated as standard for high performance and economy. Your benefit: Eliminate the need for an additional non-return valve in line!

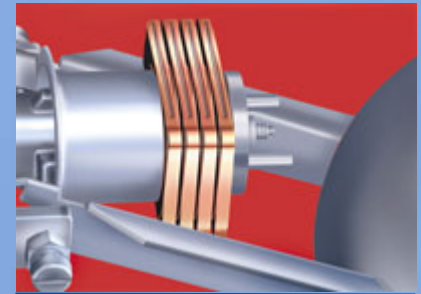
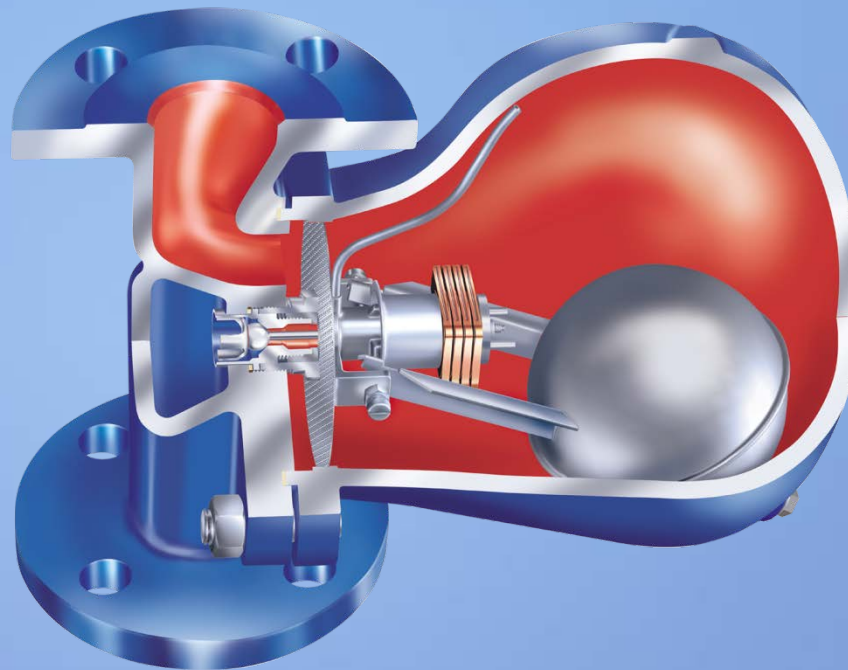

Rapid system start-up possible due to thermostatic control element (air vent/liquid drainage)!

# CONA<sup>®</sup> S - Variants

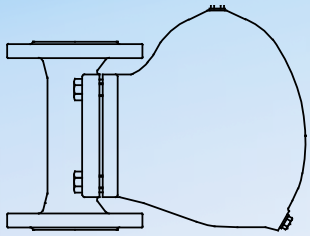

- ▶ Ball float steam trap for drainage of water from compressed air and gas systems

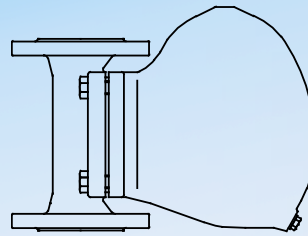

- ▶ Ball float steam trap with inside strainer for steam range

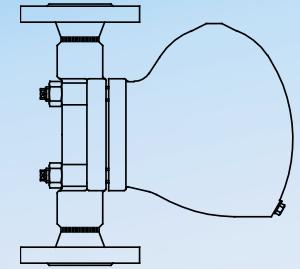

- ▶ Ball float steam trap with inside strainer  
PN63 / PN100

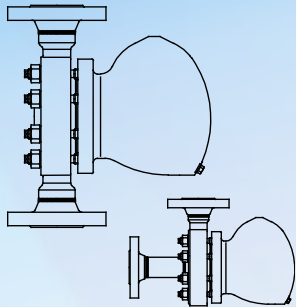

- ▶ Ball float steam trap  
PN160

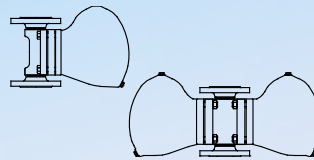

- ▶ Ball float steam trap with inside strainer and pilot operated for steam range

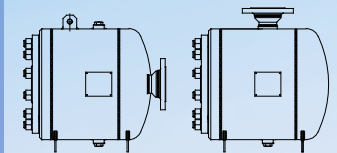

- ▶ Ball float steam trap with inside strainer and pilot operated for steam range